

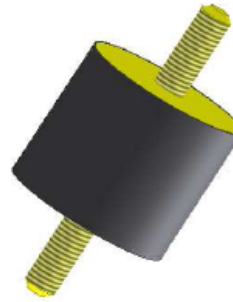

### Circolari TYPE VV

Una gamma completa di supporti con fissaggio a filettatura maschio da entrambi i lati, che possono essere utilizzati in compressione, taglio o compressione-taglio combinati. Le parti metalliche sono stampate o saldate a seconda della grandezza dell'antivibrante. Dimensioni da 8 a 150 mm. con carichi applicati da pochi N ad oltre 1.000 daN.

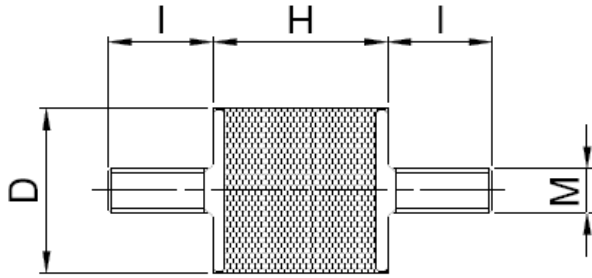

#### CAMPO DI IMPIEGO

- Apparecchi di misura
- Strumentazioni
- Piccole macchine in genere
- Motori elettrici
- Pompe
- Radiatori

Item 型号	D	H	M x l	平均压缩量 橡胶硬度 45 IRHD (daN/mm) 公斤/每毫米	平均压缩量 橡胶硬度 60 IRHD (daN/mm) 公斤/每毫米	平均压缩量 橡胶硬度 70 IRHD (daN/mm) 公斤/每毫米	Maximale statische Einfederung 最大适当压缩量(mm)
1008VV10	10	8	M4X10	3.8	7.2	11.3	1.6
1508VV10	15	8	M4X10	12.8	23.5	32.5	1.6
1510VV10	15	10	M4X10	8.6	14.7	21.1	1.8
1615VV10	16	15	M4X10	6.5	12.2	15.8	3.0
1885VV16	18	8.5	M6X16	17.2	32.5	45.0	1.7
2008VV18	20	8	M6X18	19.2	35.0	48.3	1.6
2015VV18	20	15	M6X18	7.5	14.2	19.2	3.0
2020VV18	20	20	M6X18	4.4	8.1	11.3	4.0
2025VV18	20	25	M6X18	3.0	5.5	7.7	5.0
2030VV18	20	30	M6X18	2.0	3.7	5.2	6.0
2510VV18	25	10	M6X18	27.8	53.3	73.3	2.0
2515VV18	25	15	M6X18	15.0	28.3	40.0	3.0
2520VV18	25	20	M6X18	10.0	18.1	24.4	4.0
2520VV20	25	20	M8X20	10.0	18.1	24.4	4.0
2522VV20	25	22	M8X20	8.0	15.0	20.0	4.4
2525VV18	25	25	M6X18	5.9	11.0	15.2	5.0
2525VV20	25	25	M8X20	5.9	11.0	15.2	5.0
2530VV18	25	30	M6X18	4.3	8.1	10.7	6.0
2530VV20	25	30	M8X20	4.3	8.1	10.7	6.0
2540VV20	25	40	M8X20	2.7	5.3	7.2	6.0
3015VV20	30	15	M8X20	20.0	37.3	51.8	3.0
3020VV20	30	20	M8X20	12.5	23.8	31.9	4.0
3025VV20	30	25	M8X20	8.1	11.2	15.4	5.0
3030VV14	30	30	M6X14				
3030VV20	30	30	M8X20	5.8	10.8	14.6	6.0
3035VV23	30	35	M8X23				
3040VV20	30	40	M8X20	4.5	7.6	10.0	8.0
3540VV23	35	40	M8X23				
4015VV23	40	15	M8X23				
4020VV23	40	20	M8X23	25.6	48.1	66.3	4.0
4020VV25	40	20	M10X25	25.6	48.1	66.3	4.0
4025VV25	40	25	M10X25	18.1	33.8	46.2	5.0
4025VV28	40	25	M12X28	18.1	33.8	46.2	5.0
4028VV25	40	28	M10X25	14.6	27.1	37.1	5.6



4030VV23	40	30	M8X23	12.7	23.8	33.5	6.0
4030VV25	40	30	M10X25	12.7	23.8	33.5	6.0
4035VV23	40	35	M8X23	9.7	18.1	25.2	7.0
4035VV25	40	35	M10X25	9.7	18.1	25.2	7.0
4040VV23	40	40	M8X23	8.1	15.0	20.6	8.0
4040VV25	40	40	M10X25	8.1	15.0	20.6	8.0
4045VV25	40	45	M10X25	6.8	12.7	1.7	9.0
5020VV25	50	20	M10X25	56.7	106.0	146.0	4.0
5025VV25	50	25	M10X25	39.5	73.5	101.5	5.0
5030VV25	50	30	M10X25	27.2	50.0	69.2	6.0
5033VV25	50	33	M10X25	22.4	41.0	56.9	6.6
5035VV25	50	35	M10X25	19.7	36.7	50.3	7.0
5040VV25	50	40	M10X25	14.0	26.0	36.0	8.0
5045VV25	50	45	M10X25	11.0	20.5	28.5	9.0
5050VV25	50	50	M10X25	8.9	16.9	23.1	8.0
6025VV25	60	25	M10X25	61.0	113.5	157.0	5.0
6030VV25	60	30	M10X25	43.2	80.0	110.4	6.0
6030VV37	60	30	M12X37	43.2	80.0	110.4	6.0
6035VV25	60	35	M10X25				
6036VV25	60	36	M10X25	34.2	63.5	87.7	7.2
6036VV37	60	36	M12X37	34.2	63.5	87.7	7.2
6040VV25	60	40	M10X25	28.0	52.3	71.1	8.0
6040VV37	60	40	M12X37	28.0	52.3	71.1	8.0
6045VV25	60	45	M10X25	22.3	41.5	57.5	9.0
6045VV37	60	45	M12X37	22.3	41.5	57.5	9.0
6050VV37	60	50	M12X37	17.8	33.1	45.6	10.0
6535VV25	65	35	M10X25	43.0	80.0	110.7	8.0
6545VV37	65	45	M12X37	25.0	46.3	64.0	9.0
6550VV37	65	50	M12X37	19.1	35.1	48.9	10.0
7030VV25	70	30	M10X25	70.8	132.1	180.0	6.0
7030VV37	70	30	M12X37	70.8	132.1	180.0	6.0
7035VV25	70	35	M10X25	57.1	102.8	141.7	7.0
7035VV37	70	35	M12X37	57.1	102.8	141.7	7.0
7040VV25	70	40	M10X25	40.9	75.9	105.0	8.0
7040VV37	70	40	M12X37	40.9	75.9	105.0	8.0
7045VV25	70	45	M10X25	32.1	59.5	80.0	9.0
7045VV37	70	45	M12X37	32.1	59.5	80.0	9.0
7050VV25	70	50	M10X25	25.9	48.0	66.4	10.0
7050VV37	70	50	M12X37	25.9	48.0	66.4	10.0
7070VV25	70	70	M10X25	16.9	31.3	43.4	14
7070VV37	70	70	M12X37	16.9	31.3	43.4	14
7525VV37	75	25	M12X37	116.3	221.1	303.7	5
7540VV37	75	40	M12X37	44.1	82.4	113.5	8
7550VV37	75	50	M12X37	32.5	60.9	84.1	10
7555VV37	75	55	M12X37	25.5	48	66.1	11
8030VV35	80	30	M14X35	112.5	213.3	293.3	6
8040VV35	80	40	M14X35	60	112.1	155	8
8050VV35	80	50	M14X35	39.8	75	103.2	10
8060VV35	80	60	M14X35	26.7	50	68.5	12
10030VV44	100	30	M16X44	209.1	400	550	6
10040VV44	100	40	M16X44	115.6	209.4	289.1	8
10050VV44	100	50	M16X44	69	125	172.6	10
10055VV44	100	55	M16X44	57.4	106.4	146.8	11
10060VV44	100	60	M16X44	50	90.4	125	12
10075VV44	100	75	M16X44	32.1	56.7	78.4	15
12540VV45	125	40	M16X44				
12560VV44	125	60	M16X44				
15075VV44	150	75	M16X44	97	178.5	246.4	15